



B&C

BARESI & CAINE

SWITZERLAND



TABLE OF CONTENTS

Page 1-3	The Story Of Baresi & Caine
Page 4-10	Concept & Design
Page 11-13	Marble Designs From Tuscany
Page 14-15	La Chaux -De- Fonds
Page 16-29	The Stella Luce
Page 31-43	The Sportivo Lusso
Page 44-51	The Luce
Page 52-63	The Sportivo
Page 64-73	The Sportivo 18ct Gold
Page 74-84	The Lady Luce
Page 85-87	Swiss Automatic Movement
Page 88	Aquila Tourbillon Concept





"IF TIME IS ALL WE HAVE,
MAKE A STATEMENT."

B&C
BARESI & CAINE



THE STORY OF BARESI & CAINE

Our story begins in early 2016 with our Company Founder's first visit to Rome, Italy. Overwhelmed with the vast architecture and beautiful materials, specifically the Fontana dei Quattro Fiumi at Piazza Navona, and with a lifelong love for watches, he had the vision that he would design and create a timepiece for himself made from marble, capturing the beauty and luxury of the material in a small wearable piece.

Several months later he began development of the first of the Baresi & Caine Collection timepiece which moved from initial concept to final design and manufacture in twelve months.

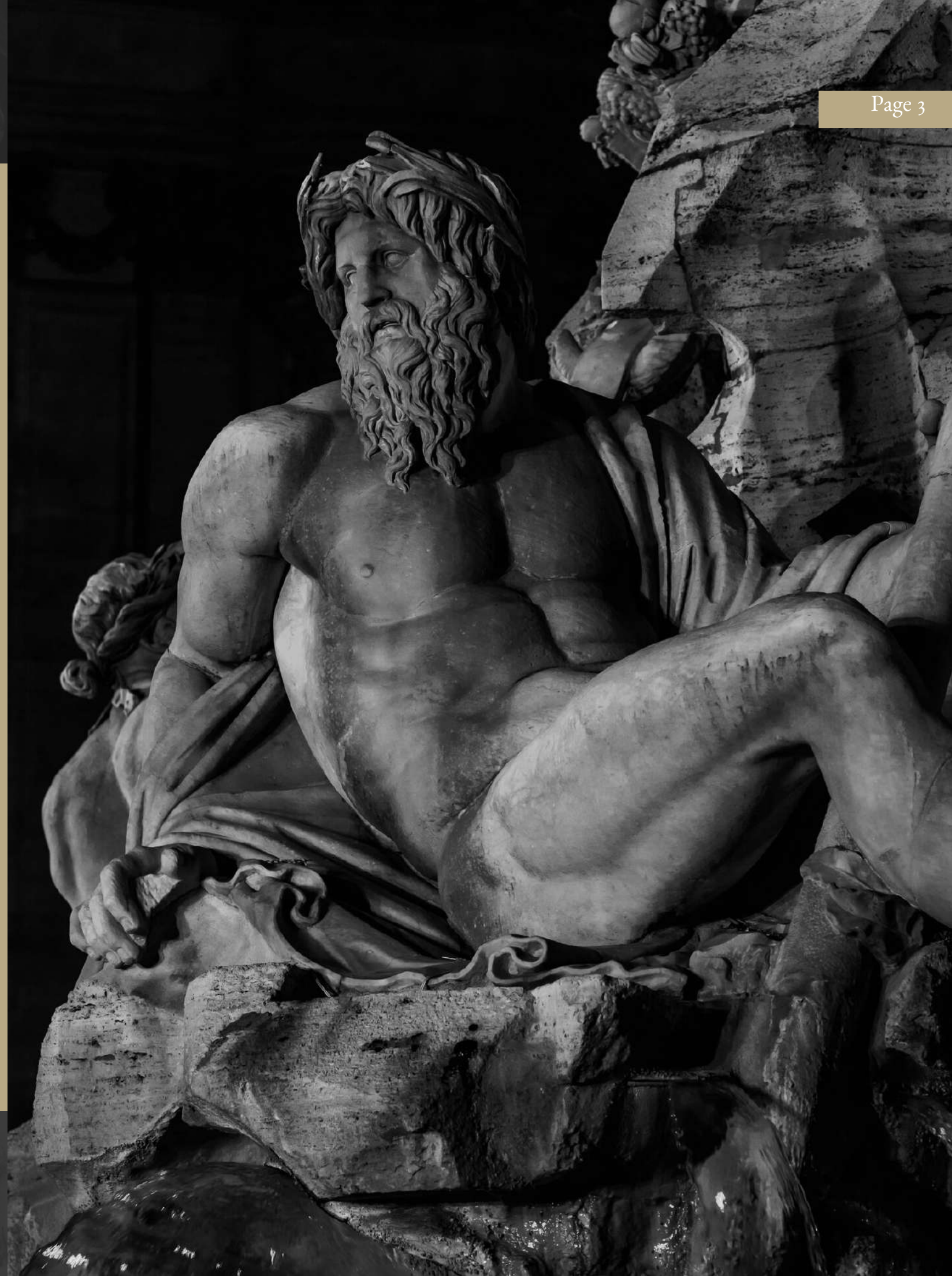

CONCEPT & DESIGN

Four years later, in Spring 2020, with numerous concept's and designs completed and with designs in development, with a hunger to expand the business and to make his brand known, Baresi & Caine approached and agreed to a partnership with a designer with over 20 year's experience in conceptual and detail design. This partnership was the beginning of the Stella Luce and Sportivo Lusso, our 2022 Collection.

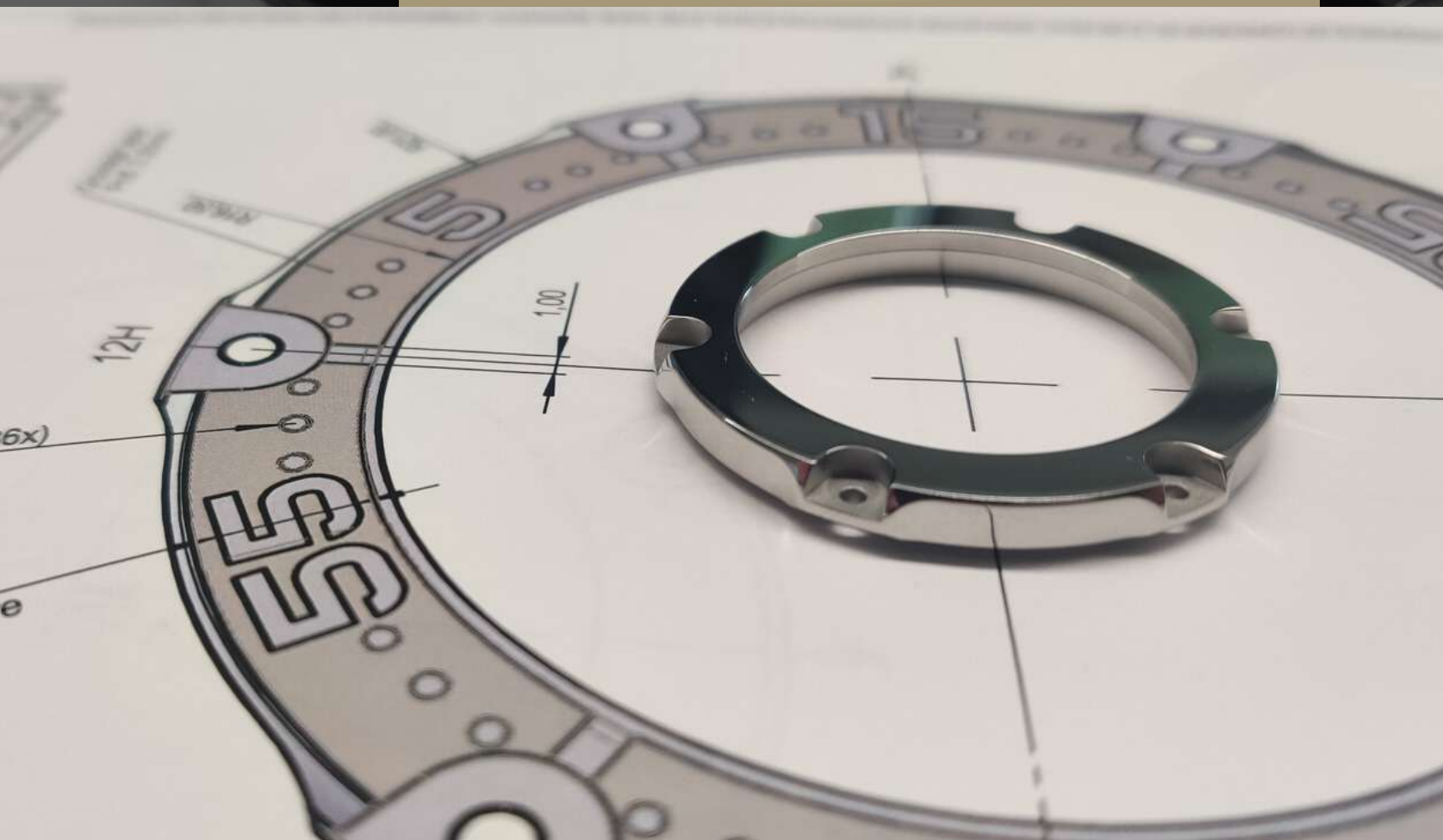



PLATINUM SPORTIVO LUSO
SP22220

Cotes en mm / Tol. en
Spéc.
Ens.





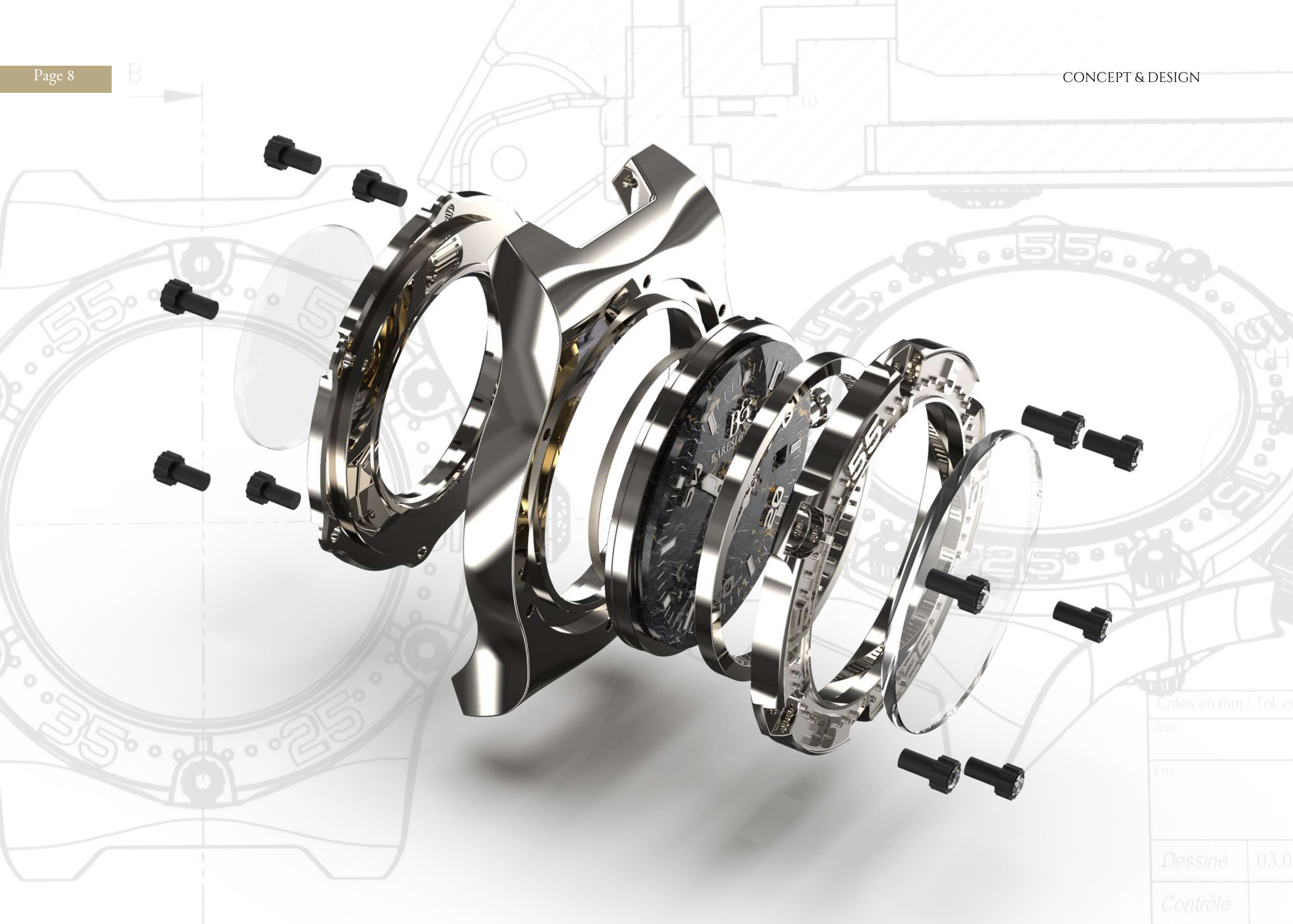

Cotes en mm / Tol. en

Spéc

Ens

Dessiné

03.0

Contrôle



Rep	Qté	Article	Désignation
1	1	GRP-31.50X1.90-00	
2	12	F99.020	
3	1	JGR-32.10X1.40-00	
4	1	1425	
5	1		
6	1		
7	1		
8	1		
9	1		
10	1		
11			
12			
13			
14			
15			
16			
17			
18			

14	2
15	1
16	1
17	1
18	1

00-REH-1
1425-00-CAR-1
F20.005
F21.003
1425-00-CAD-1
CER-1

35.50 X 0.80
0-FON-1
1.10-00
00 X1.40-00



PLATINUM STELLA LUCE
SL22230

MARBLE DIALS FROM TUSCANY

Baresi & Caine timepieces feature exquisite designs designed and manufactured using a high grade selection of marbles from around the world. Each individual marble dial is completely unique, no Baresi & Caine watch will ever look the same.

CARRARA

Baresi & Caine utilise Carrara marble specifically sourced from The Apuane Alps in the central region of Tuscany, a mountain range in central Italy. A world-famous highly sought after ice white marble with grey blue veins, stating undeniable beauty.

NERO PORTORO

Quarried in Italy, Nero Portoro marble is naturally opulent which transpires to give diversity to the timepiece. This beauty is evident within the deep lacunas of jet black and mesmerising golden veins, a most perfect combination of elegance.

BLUE SODALITE

Precious, rare, stupefying. The vibrant beauty of Blue Sodalite makes every Baresi & Caine timepiece distinctive, Thanks to the shallow chromatic mixes, sophisticated and intense, and the material's resilience, this fine natural stone earned its place in our luxury collection.









LA CHAUX-DE-FONDS SWITZERLAND

Baresi & Caine strived to be the best as a watch brand and collaborated with working partners in La Chaux-De-Fonds, Switzerland. This epicentre of watchmaking is the birthplace of all Baresi & Caine timepieces.

LA GRANDE FONTAINE

LA CHAUX-DE-FONDS





STELLA LUCE
COLLECTION I

STAR LIGHT

When style and statement is everything the Stella Luce 'STAR LIGHT' is the only choice. This watch combines classic luxury and modern smooth lines to create a striking yet timeless look.

Handcrafted to perfection, the Stella Luce has a choice of three stunning marble dials; Blue Sodalite, Italian Carrara and Nero Portoro.





LET THERE BE LIGHT

To reveal the opulent aesthetics of the Swiss automatic movement, the Stella Luce features a stunning double anti reflective coated sapphire showcase back.

This theme is continued throughout via its ingeniously engineered 1ct diamond set crown along with the accompanying diamond set bezel and diamond set caseback. Each diamond emits a subtle starlight glow throughout the night.

This is a first in watchmaking history.

An astonishingly complex engineering feat accomplished by incorporating each diamond in an ultra-modern dodecagon screw head and crown, exclusively developed in-house by Baresi & Caine.







Designed and crafted to the highest possible standards, you can be assured of a robust, reliable and accurate timekeeper whose quality and looks are perfectly matched.

With Super Luminous hands offset against the smooth sweeping second hand this watch is a true statement piece.

Finished with double anti-reflective coating on the sapphire glass, every detail of this magnificent timepiece marks it out as Baresi & Caine.

The Stella Luce is available in 18ct Gold, 18ct Rose Gold, Platinum, White Zirconia, Black Zirconia and 904L Stainless Steel.

PRECIOUS METALS





STELLA LUCE
A LEGEND IS BORN

STELLA LUCE

18CT YELLOW GOLD



Model No SL11120

18ct Gold 44mm Case
 18ct Gold Bezel
 18ct Gold Caseback
 Nero Portoro Dial
 Platinum Sub Bezel
 Starlight Diamond Crown
 6 Diamond Set Showcase Back
 6 Diamond Set Bezel
 Black Leather Strap
 18ct Gold Clasp
 Water Resistant 3ATM



Model No SL11130

18ct Gold 44mm Case
 18ct Gold Bezel
 18ct Gold Caseback
 Carrara Dial
 Platinum Sub Bezel
 Starlight Diamond Crown
 6 Diamond Set Showcase Back
 6 Diamond Set Bezel
 Black Leather Strap
 18ct Gold Clasp
 Water Resistant 3ATM



Model No SL11140

18ct Gold 44mm Case
 18ct Gold Bezel
 18ct Gold Caseback
 Blue Sodalite Dial
 Platinum Sub Bezel
 Starlight Diamond Crown
 6 Diamond Set Showcase Back
 6 Diamond Set Bezel
 Navy Blue Leather Strap
 18ct Gold Clasp
 Water Resistant 3ATM

P r i c e s s t a r t f r o m £ 5 7 , 9 0 0

STELLA LUCE

18CT ROSE GOLD



Model No SL55520

18ct Rose Gold 44mm Case
18ct Rose Gold Bezel
18ct Rose Gold Caseback
Nero Portoro Dial
Platinum Sub Bezel
Starlight Diamond Crown
6 Diamond Set Showcase Back
6 Diamond Set Bezel
Black Leather Strap
18ct Rose Gold Clasp
Water Resistant 3ATM



Model No SL55530

18ct Rose Gold 44mm Case
18ct Rose Gold Bezel
18ct Rose Gold Caseback
Carrara Dial
Platinum Sub Bezel
Starlight Diamond Crown
6 Diamond Set Showcase Back
6 Diamond Set Bezel
Black Leather Strap
18ct Rose Gold Clasp
Water Resistant 3ATM



Model No SL55540

18ct Rose Gold 44mm Case
18ct Rose Gold Bezel
18ct Rose Gold Caseback
Blue Sodalite Dial
Platinum Sub Bezel
Starlight Diamond Crown
6 Diamond Set Showcase Back
6 Diamond Set Bezel
Navy Blue Leather Strap
18ct Rose Gold Clasp
Water Resistant 3ATM

Prices start from £57,900

STELLA LUCE

PLATINUM

**Model No SL22220**

Platinum 44mm Case
Platinum Bezel
Platinum Caseback
Nero Portoro Dial
Platinum Sub Bezel
Starlight Diamond Crown
6 Diamond Set Showcase Back
6 Diamond Set Bezel
Black Leather Strap
Platinum Clasp
Water Resistant 3ATM

**Model No SL22230**

Platinum 44mm Case
Platinum Bezel
Platinum Caseback
Carrara Dial
Platinum Sub Bezel
Starlight Diamond Crown
6 Diamond Set Showcase Back
6 Diamond Set Bezel
Arctic White Leather Strap
Platinum Clasp
Water Resistant 3ATM

**Model No SL22240**

Platinum 44mm Case
Platinum Bezel
Platinum Caseback
Blue Sodalite Dial
Platinum Sub Bezel
Starlight Diamond Crown
6 Diamond Set Showcase Back
6 Diamond Set Bezel
Navy Blue Leather Strap
Platinum Clasp
Water Resistant 3ATM

P r i c e s s t a r t f r o m £ 5 9 , 9 0 0

STELLA LUCE

ZIRCONIA



Model No SL31130

White Zirconia 44mm Case
 18ct Gold Bezel
 18ct Gold Caseback
 Carrara Dial
 Platinum Sub Bezel
 Starlight Diamond Crown
 6 Diamond Set Showcase Back
 6 Diamond Set Bezel
 Arctic White Leather Strap
 18ct Gold Clasp
 Water Resistant 3ATM



Model No SL41120

Black Zirconia 44mm Case
 18ct Gold Bezel
 18ct Gold Caseback
 Nero Portoro Dial
 Platinum Sub Bezel
 Starlight Diamond Crown
 6 Diamond Set Showcase Back
 6 Diamond Set Bezel
 Black Leather Strap
 18ct Gold Clasp
 Water Resistant 3ATM

P r i c e s s t a r t f r o m £ 4 9 , 9 0 0

STELLA LUCE

STAINLESS STEEL



Model No SL77730

904L Stainless Steel 44mm Case
904L Stainless Steel Bezel
904L Stainless Steel Caseback
Carrara Dial
Starlight Diamond Crown
6 Diamond Set Showcase Back
6 Diamond Set Bezel
Black Leather Strap
904L Stainless Steel Clasp
Water Resistant 3ATM

P r i c e s s t a r t f r o m £ 3 7 , 4 0 0

SPORTIVO LUSO

Page 31

SPORTIVO LUSO

COLLECTION II



STRENGTH IN DESIGN

Encapsulating its familial DNA from the Modello Stella Luce, the Sportivo Lusso builds on that successful design ethos by incorporating subtle visual clues which hint at its heritage.

A watch respecting the foundations of the luxurious Stella Luce, evincing a strong and masculine character whilst combining all new features, such as wider lugs, broader shoulders and unique Arabic numerals complementing the Bezel & Marble Dial.





Beautifully sculpted surfaces highlight the intricate detail of the Bezel and Case Back which ingeniously harness diamond set screws.

Another dash of uniqueness in watchmaking brought to you by Baresi & Caine.

The stunning fascia is complemented by the intricate bezel surround which gloriously counterpoints the smooth lines of the case to create a feel of luxury and substance.

A TRUE STATEMENT PIECE







A CREATION ADMIRER

Working with the most luxurious materials available, the Sportivo Lusso is a horological creation which can be truly admired. Every Sportivo Lusso timepiece is complimented with either a sports rubber or leather strap, both combined with our own unique fold-over clasp.

A Baresi & Caine timepiece is a one of a kind, bespoke to every client, truly understated and effortlessly stylish timepiece. Each one is born with its own unique number registered to each individual customer.

SPORTIVO LUSO

18CT YELLOW GOLD



Model No SP11120

18ct Gold Case
18ct Gold Bezel
18ct Gold Caseback
Nero Portoro Dial
Platinum Sub Bezel
1CT Diamond Crown
6 Diamond Set Showcase Back
6 Diamond Set Bezel
Black Sports Strap
18ct Gold Clasp
Water Resistant 3ATM



Model No SP11130

18ct Gold Case
18ct Gold Bezel
18ct Gold Caseback
Carrara Dial
Platinum Sub Bezel
1CT Diamond Crown
6 Diamond Set Showcase Back
6 Diamond Set Bezel
White Sports Strap
18ct Gold Clasp
Water Resistant 3ATM



Model No SP11140

18ct Gold Case
18ct Gold Bezel
18ct Gold Caseback
Blue Sodalite Dial
Platinum Sub Bezel
1CT Diamond Crown
6 Diamond Set Showcase Back
6 Diamond Set Bezel
Navy Blue Sports Strap
18ct Gold Clasp
Water Resistant 3ATM

Prices start from £55,900

SPORTIVO LUSO

18CT ROSE GOLD



Model No SP55520

18ct Rose Gold Case
18ct Rose Gold Bezel
18ct Rose Gold Caseback
Nero Portoro Dial
Platinum Sub Bezel
1CT Diamond Crown
6 Diamond Set Showcase Back
6 Diamond Set Bezel
Black Sports Strap
18ct Rose Gold Clasp
Water Resistant 3ATM



Model No SP55530

18ct Rose Gold Case
18ct Rose Gold Bezel
18ct Rose Gold Caseback
Carrara Dial
Platinum Sub Bezel
1CT Diamond Crown
6 Diamond Set Showcase Back
6 Diamond Set Bezel
White Sports Strap
18ct Rose Gold Clasp
Water Resistant 3ATM



Model No SP55540

18ct Rose Gold Case
18ct Rose Gold Bezel
18ct Rose Gold Caseback
Blue Sodalite Dial
Platinum Sub Bezel
1CT Diamond Crown
6 Diamond Set Showcase Back
6 Diamond Set Bezel
Navy Blue Sports Strap
18ct Rose Gold Clasp
Water Resistant 3ATM

Prices start from £55,900

SPORTIVO LUSO

PLATINUM



Model No SP22220

Platinum Case
Platinum Bezel
Platinum Caseback
Nero Portoro Dial
Platinum Sub Bezel
1CT Diamond Crown
6 Diamond Set Showcase Back
6 Diamond Set Bezel
Black Sports Strap
Platinum Clasp
Water Resistant 3ATM



Model No SP22230

Platinum Case
Platinum Bezel
Platinum Caseback
Carrara Dial
Platinum Sub Bezel
1CT Diamond Crown
6 Diamond Set Showcase Back
6 Diamond Set Bezel
Orange Sports Strap
Platinum Clasp
Water Resistant 3ATM



Model No SP22240

Platinum Case
Platinum Bezel
Platinum Caseback
Blue Sodalite Dial
Platinum Sub Bezel
1CT Diamond Crown
6 Diamond Set Showcase Back
6 Diamond Set Bezel
Navy Blue Sports Strap
Platinum Clasp
Water Resistant 3ATM

Prices start from £57,900

SPORTIVO LUSO

ZIRCONIA



Model No SP31120

White Zirconia Case
 18ct Gold Bezel
 18ct Gold Caseback
 Nero Portoro Dial
 Platinum Sub Bezel
 1CT Diamond Crown
 6 Diamond Set Showcase Back
 6 Diamond Set Bezel
 White Sports Strap
 18ct Gold Clasp
 Water Resistant 3ATM



Model No SP31130

White Zirconia Case
 18ct Gold Bezel
 18ct Gold Caseback
 Carrara Dial
 Platinum Sub Bezel
 1CT Diamond Crown
 6 Diamond Set Showcase Back
 6 Diamond Set Bezel
 White Sports Strap
 18ct Gold Clasp
 Water Resistant 3ATM

P r i c e s s t a r t f r o m £ 3 9 , 5 0 0

SPORTIVO LUSO

ZIRCONIA



Model No SP41120

Black Zirconia Case
18ct Gold Bezel
18ct Gold Caseback
Nero Portoro Dial
Platinum Sub Bezel
1CT Diamond Crown
6 Diamond Set Showcase Back
6 Diamond Set Bezel
Red Sports Strap
18ct Gold Clasp
Water Resistant 3ATM



Model No SP41130

Black Zirconia Case
18ct Gold Bezel
18ct Gold Caseback
Carrara Dial
Platinum Sub Bezel
1CT Diamond Crown
6 Diamond Set Showcase Back
6 Diamond Set Bezel
White Sports Strap
18ct Gold Clasp
Water Resistant 3ATM

Prices start from £39,500

SPORTIVO LUSO

STAINLESS STEEL



Model No SP77730

904L Stainless Steel Case
904L Stainless Steel Bezel
904L Stainless Steel Caseback
Nero Portoro Dial
1CT Diamond Crown
6 Diamond Set Showcase Back
6 Diamond Set Bezel
Aqua Blue Sports Strap
904L Stainless Steel Clasp
Water Resistant 3ATM



Model No SP77730

904L Stainless Steel Case
904L Stainless Steel Bezel
904L Stainless Steel Caseback
Nero Portoro Dial
1CT Diamond Crown
6 Diamond Set Showcase Back
6 Diamond Set Bezel
Neon Green Sports Strap
904L Stainless Steel Clasp
Water Resistant 3ATM



Model No SP77730

904L Stainless Steel Case
904L Stainless Steel Bezel
904L Stainless Steel Caseback
Nero Portoro Dial
1CT Diamond Crown
6 Diamond Set Showcase Back
6 Diamond Set Bezel
Pink Sports Strap
904L Stainless Steel Clasp
Water Resistant 3ATM

Prices start from £35,400

THE LUCE
COLLECTION III





The Piazza Navona is one of the most beautiful and famous squares in Rome with its splendid Baroque masterpieces by Bernini and Borromini, the beautiful marble statues were the light of inspiration that inspired Baresi & Caine to design The Luce.

The Luce is a timepiece that exudes elegance and sophistication. Unlike its counterpart, the Stella Luce, it doesn't feature any diamonds. However, this doesn't detract from its beauty, as the watch is designed to make a statement on its own.

One of the most notable features of The Luce is its dial, which is made from Carrara marble mined from Tuscany. This exquisite material gives the watch a unique and timeless quality that is unparalleled by other timepieces.

THE FOUNTAIN OF THE FOUR RIVERS



The inspiration for The Luce came from the company director's first visit to Rome, where he was struck by the beauty of the Piazza Navona. The grandeur of the architecture and the elegance of the fountains and sculptures left a lasting impression on him, and he decided to create a watch that captured that same sense of distinction and elegance.

The craftsmanship that has gone into creating The Luce is truly exceptional. From the precision of the Swiss automatic BC100-S movement to the attention to detail in the design, every aspect of the watch has been carefully considered and executed to the highest standards. The leather strap is made from the finest Italian leather and comes with a choice of colours. The stainless steel case has been expertly crafted to ensure durability and longevity.



The Luce by Baresi & Caine is a beautiful watch that stands out from the crowd. The sleek lines and smooth edges really sets it apart from other watches, while its excellent craftsmanship ensures that it will last for years to come. This is a timepiece that is sure to turn heads and make a statement wherever it is worn.



Baresi & Caine is a brand that prides itself on its attention to detail. The company has a reputation for producing watches that are not only beautiful but also meticulously crafted. One example of this is the screws used in The Luce.

The design of the screws were inspired by the Roman columns, which are known for their elegance and strength. By incorporating this design element, Baresi & Caine has added an extra level of visual interest to the watch.

Indeed all Baresi & Caine watches, exude the spirit and energy of Italy. The country is known for its rich history, art, and culture, and this is reflected in the design of the watch. The attention to detail, the use of fine materials, and the incorporation of inspired Italian architecture all contribute to a watch that bursts with life and vitality.



To truly appreciate the beauty and complexity of the BC100-S movement, it features a showcase back that allows the wearer to see the intricate inner workings of the watch. This is a feature that is sure to impress any watch enthusiast and is a testament to the attention to detail that goes into the design and construction of each timepiece.

This is a watch designed to last for generations. The movement's accuracy is achieved through a combination of high-quality materials and expert craftsmanship. The Swiss automatic movement is renowned for its reliability and is widely considered one of the best in the industry. Baresi & Caine has taken this already impressive technology and enhanced it even further, ensuring that each timepiece they create is both precise and reliable.

In addition to its technical prowess, the BC100-S movement is also aesthetically pleasing. The rotor is decorated with the beautiful Baresi & Caine logo, adding a touch of elegance to this stunning creation.

Its beauty and reliability ensure that it will be cherished for generations to come, making it an excellent investment for watch enthusiasts and collectors alike.

THE LUCE

STAINLESS STEEL



Model No TL77730

904L Stainless Steel Case
904L Stainless Steel Bezel
904L Stainless Steel Showcase Back
Carrara Dial
12 Dodecagon Screws
Choice of Black, Brown Leather Strap
904L Stainless Steel Clasp
Water Resistant 3ATM
Sapphire Glass With Anti Reflective
Coating
BC101-S Swiss Automatic Movement
42hrs Power Reserve

Price £19,900



THE SPORTIVO

COLLECTION IV





SIMPLICITY

Simplicity, an often misunderstood concept.
To pare an idea to its elemental state yet retain its
essence, its form and function. That's the challenge.

From the exquisite naivety of a Van Gogh painting, to the clean lines of the iconic Golden Gate bridge, these are ideas unfettered by the unnecessary, made stronger by their clarity.









SIMPLICITY

Simplicity is an often misunderstood concept.

WE UNDERSTAND





THE SPORTIVO

BARESİ & CAINE

SIMPLICITY
UNDERSTOOD





BC101-S SWISS AUTOMATIC
MOVEMENT

THE SPORTIVO

STAINLESS STEEL



Model No TS77730

904L Stainless Steel Case
904L Stainless Steel Bezel
904L Stainless Steel Showcase Back
Carrara Dial
12 Dodecagon Screws
Black Leather Strap
904L Stainless Steel Clasp
Water Resistant 3ATM
Sapphire Glass With Anti Reflective
Coating
BC101-S Swiss Automatic Movement
42hrs Power Reserve

Price £19,900

THE SPORTIVO
18CT YELLOW GOLD





The Sportivo by Baresi & Caine is a true work of art, crafted from solid 18ct yellow gold and designed with both style and functionality in mind.

The first thing that strikes you about the Sportivo is its elegant design. The watch face crafted from Italian Carrara marble is clean and simple, The 18ct yellow gold casing is sleek and perfectly complements the timeless design of the watch.

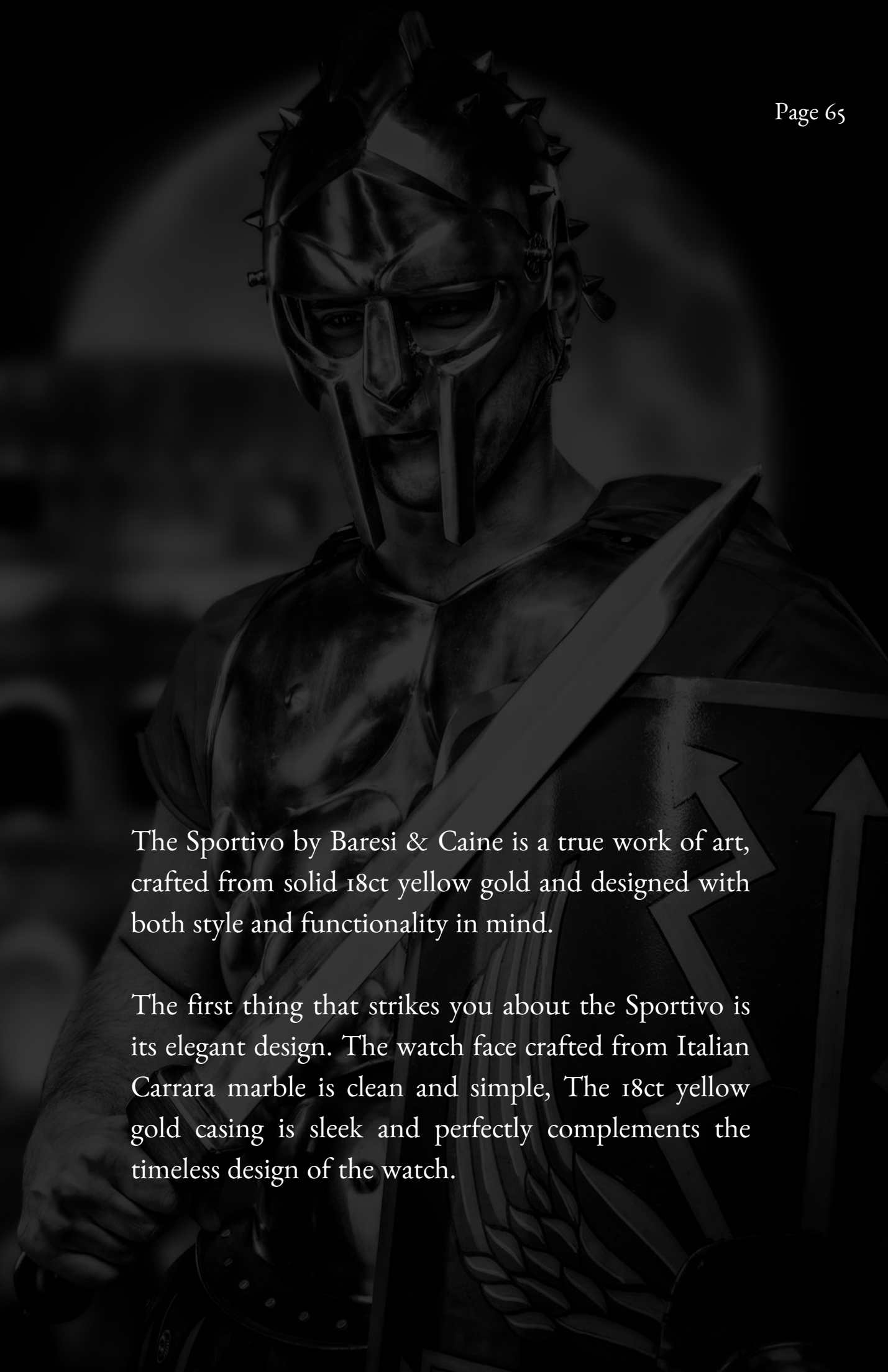



What really sets the Sportivo apart, however, is the quality of the materials used in its construction. The 18ct yellow gold is solid, and the sapphire crystal glass is scratch-resistant and highly resilient. This is a timepiece that will last for generations.

The Baresi and Caine Sportivo is a stunning watch that perfectly balances style and substance. Its combination of exquisite design and high-quality materials make it a true masterpiece, and an investment that any watch collector would be proud to own.









BC101-S SWISS AUTOMATIC
MOVEMENT





THE SPORTIVO

18CT YELLOW GOLD



Model No TS11130

18cy Yellow Gold Case
18ct Yellow Gold Bezel
18ct Yellow Gold Showcase Back
Carrara Dial
12 Dodecagon Screws
Choice of Blue, Black, Brown Leather
Strap
18ct Gold & Platinum Clasp
Water Resistant 3ATM
Sapphire Glass With Anti Reflective
Coating
BC101-S Swiss Automatic Movement
42hrs Power Reserve

Price £46,350



THE LADY LUCE

COLLECTION V

"IF TIME IS ALL WE HAVE, MAKE A STATEMENT."

BARESI & CAINE



The Lady Luce features a total of 24 diamonds, including 3 baguette diamonds and 20 round cut diamonds. The diamonds are carefully fitted to perfection on the Italian Carrara marble dial, which adds to the watch's elegance and luxurious appearance. The 3 baguette diamonds are strategically placed at the six, nine and twelve o'clock positions on the dial to provide a subtle contrast to the round cut diamonds.

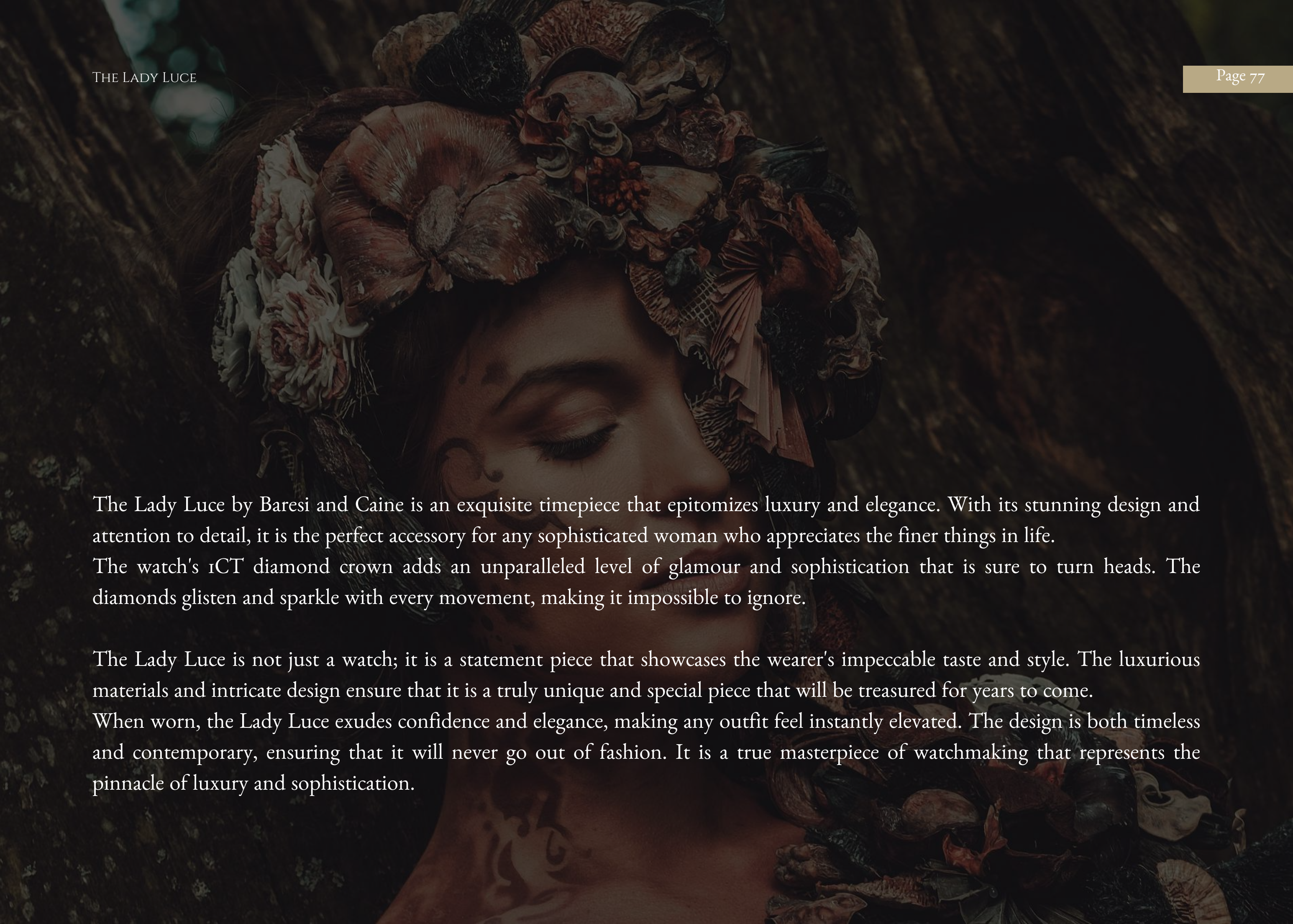

A close-up, low-angle shot of a woman's face, looking down. She is wearing a large, ornate crown made of dried flowers and leaves. Her face is painted with intricate designs, including a large, dark, swirling pattern on her forehead and cheek. The background is dark and textured, possibly a wall or a large tree trunk.

The Lady Luce by Baresi and Caine is an exquisite timepiece that epitomizes luxury and elegance. With its stunning design and attention to detail, it is the perfect accessory for any sophisticated woman who appreciates the finer things in life.

The watch's 1CT diamond crown adds an unparalleled level of glamour and sophistication that is sure to turn heads. The diamonds glisten and sparkle with every movement, making it impossible to ignore.

The Lady Luce is not just a watch; it is a statement piece that showcases the wearer's impeccable taste and style. The luxurious materials and intricate design ensure that it is a truly unique and special piece that will be treasured for years to come.

When worn, the Lady Luce exudes confidence and elegance, making any outfit feel instantly elevated. The design is both timeless and contemporary, ensuring that it will never go out of fashion. It is a true masterpiece of watchmaking that represents the pinnacle of luxury and sophistication.

THE LADY LUCE

ELEGANCE DEFINED



Prices Start From £39,600



ELEGANCE

It is said that elegance is indefinable.
An ideal so elusive that it cannot be
created. It exists..... Or it does not.

A quality of such subtlety that it is not
recognised by everyone. But for those
who see, it is unmistakable.







UNMISTAKABLE

Without introduction,
Without explanation,
Without question.

IT IS SAID THAT ELEGANCE IS INDEFINABLE.

WE DISAGREE.

THE
LADY LUCE

ELEGANCE DEFINED

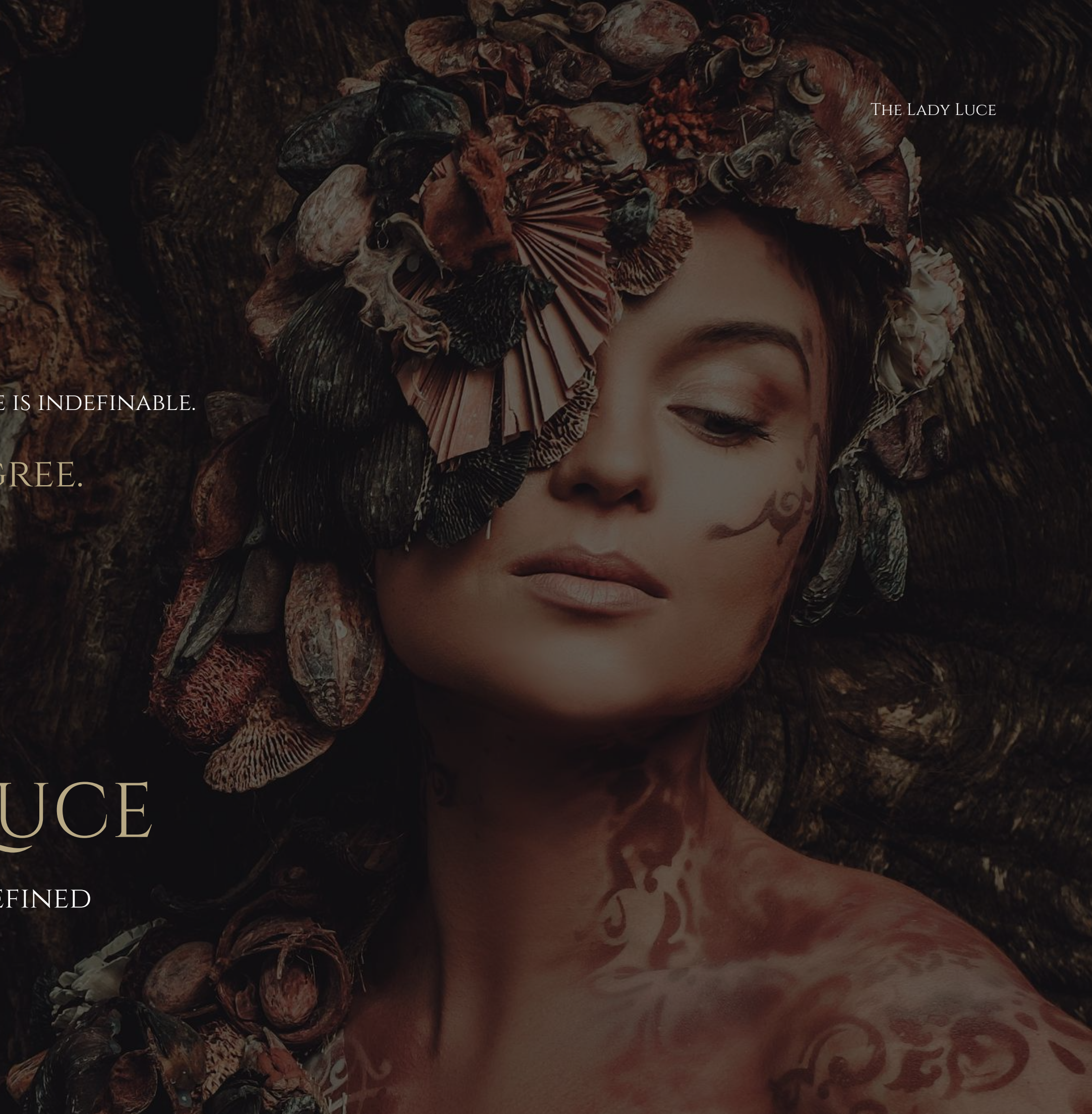



THE LADY LUCE

THE LADY LUCE

Precious Metals
Prices Start From £39,600



Model No LL11130

18CT Yellow Gold Case
18CT Yellow Gold Bezel
18CT Yellow Gold Caseback
Carrara Dial
Starlight Diamond Crown
6 Diamond Set Showcase Back
6 Diamond Set Bezel
White Leather Strap
18CT Yellow Gold & Platinum Clasp
3 Emerald Cut Diamonds & 8 Round Cut Diamonds Set Dial



Model No LL55530

18CT Rose Gold Case
18CT Rose Gold Bezel
18CT Rose Gold Caseback
Carrara Dial
Starlight Diamond Crown
6 Diamond Set Showcase Back
6 Diamond Set Bezel
Brown Leather Strap
18CT Rose Gold & Platinum Clasp
3 Emerald Cut Diamonds & 8 Round Cut Diamonds Set Dial



Model No LL11130

Platinum Case
Platinum Bezel
Platinum Caseback
Carrara Dial
Starlight Diamond Crown
6 Diamond Set Showcase Back
6 Diamond Set Bezel
Black Leather Strap
Platinum & 18CT Yellow Gold Clasp
3 Emerald Cut Diamonds & 8 Round Cut Diamonds Set Dial



Our automatic movement is equipped with a double barrel and a variable inertia balance, giving the movements increased operating stability and optimal timing.

BC101
SWISS AUTOMATIC
MOVEMENT

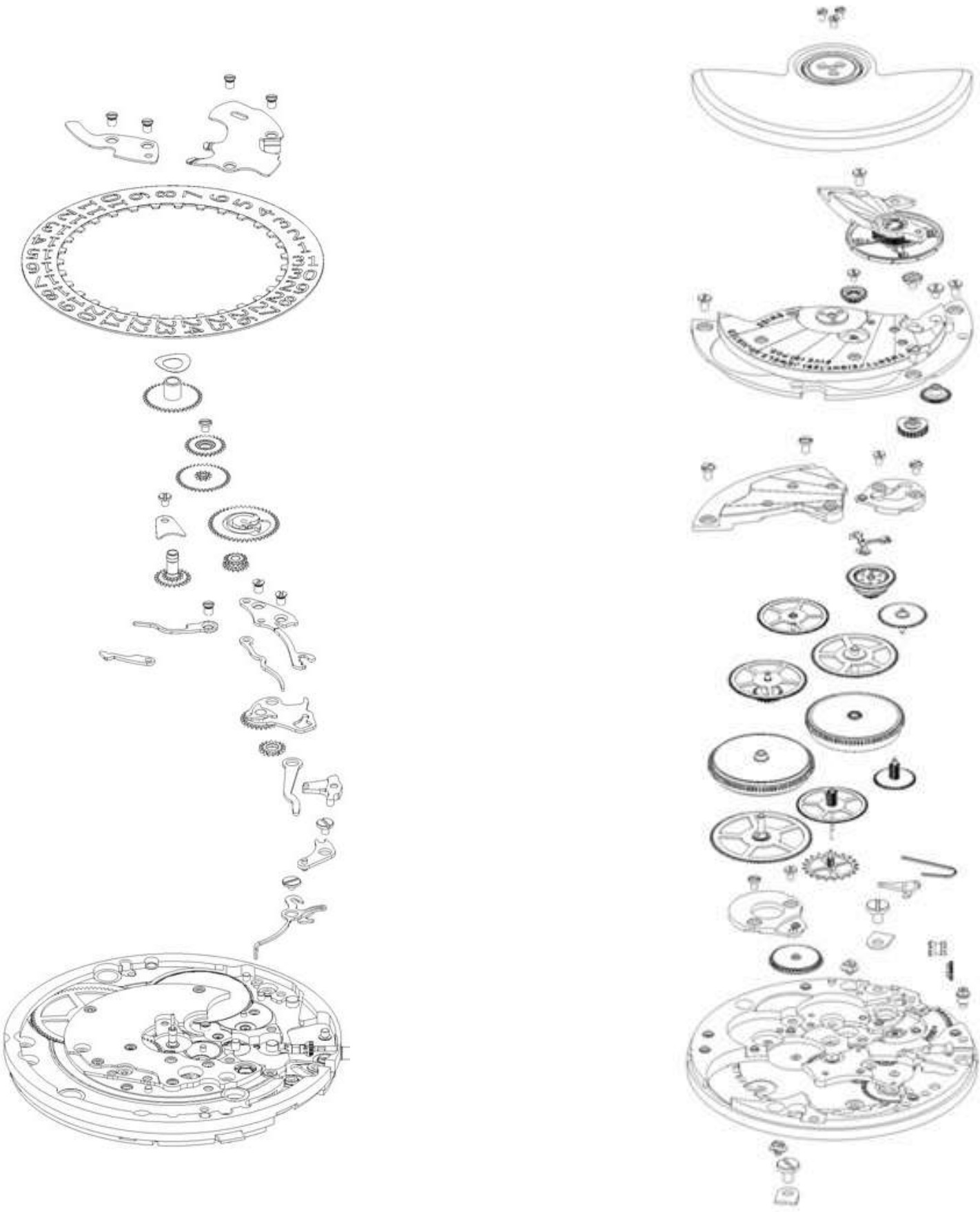

Specifications

Indications and functions - Hour, minute, date in a window at 3h

Type of balance - Variable inertia with gold inertia-blocks

Frequency - 4 Hz (28,800 A/h)

Type of balance spring - Flat

Type of oscillating weight - Tungsten

Oscillating weight winding direction - Single direction clockwise

Power Reserve - 50 hours

Chronometry - Double-barrel rapid rotation in series Variable inertia balance

Number of components - 189

Number of jewels - 28

Specific features and finishes

- Circular-grained plate on dial side and bridge side
- Date bridge and motion-work bridge, circular grained, dial side
- Bridges with Baresi & Caine decor, rhodium-plated, bicolour engraving
- Bevels, counterbores and apertures diamond-polished
- Ceramic ball-bearing
- Pivots and flanges rolled
- Wheels circular-grained on 2 faces
- Flat-head screws, locked
- Bridges hand-bevelled with piercer





AQUILA
TOURBILLON
CONCEPT



B&C

BARESI & CAINE

SWITZERLAND

BARESICAINE.COM

SWITZERLAND
COPYRIGHT 2023 ISS-006